

Southwark Park Pavilion

Southwark Park, Southwark

Client

London Borough of Southwark

Project Cost

Undisclosed

Status

Completed 2019

As part of a larger masterplan this new building sees existing park facilities; café, offices and WC's, consolidated into a single pavilion in a prominent central location overlooking the boating lake.

The design draws on the history of the park and refers to the notable listed former church building at Dilston Grove which was the first in situ concrete building in the UK.

The plan has been generated through consideration of the three key views towards the lake, the 'Oval' green space and the playground. This results in a tripartite plan which has been stretched and articulated to follow the curves of the existing paths, lake edge and trees. The building is clad in white bricks, with generous openings to allow expansive views in all three directions.

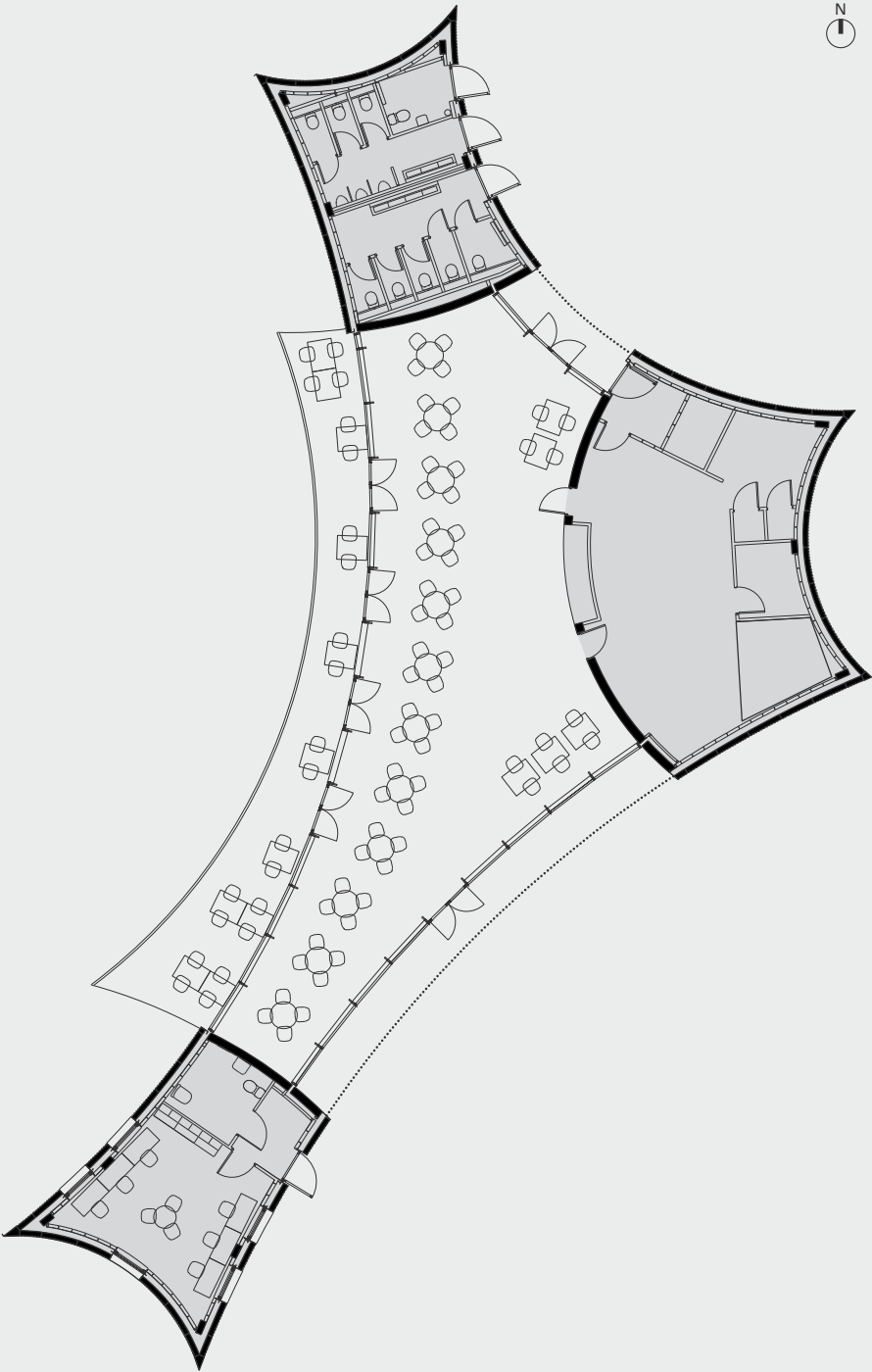

Southwark Park Pavilion / Bell Phillips Architects



