

Southwark Park Pavilion

Southwark, London

Client

London Borough of Southwark

Project Cost

Undisclosed

Status

Detailed planning consent granted

This new pavilion will bring together existing amenities within the park including a new café, WC's and a park office into a new building overlooking the boating lake. The curved geometry of the building responds to the form of the boating lake to the north-west, the oval playing fields to the south-east and the location of existing trees. The proposed café will offer excellent views across the adjacent playing fields, lake and children's playground.

The pavilion will be constructed as part of a larger masterplan on the park, being undertaken by Southwark with funding from the Arts Council.

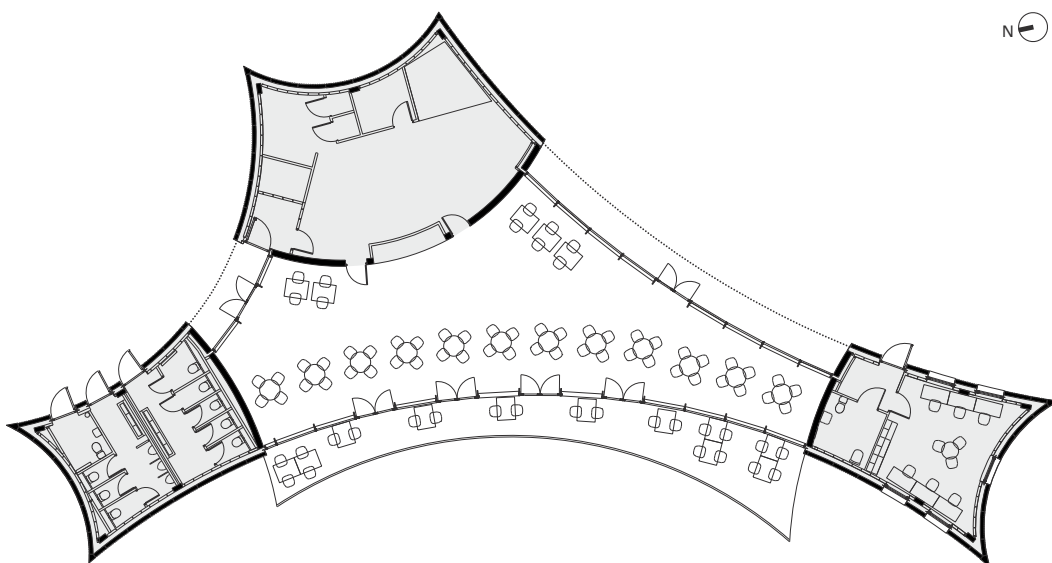

Southwark Park Pavilion / Bell Phillips Architects

